

The Harrington

Three bedroom chalet bungalow



Front view



Rear view

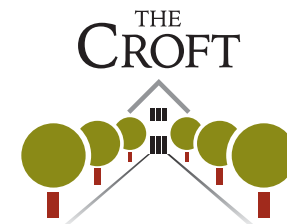

(H104)



Ground floor

Kitchen	3.60m x 4.91m 11'9" x 16'1"
Living Room	4.57m x 3.19m 14'11" x 10'5"
Dining Room / Bedroom 3	2.67m x 3.80m 8'9" x 12'5"
Shower Room	1.71m x 1.86m 5'7" x 6'1"

All measurements shown are approximate maximum room dimensions.

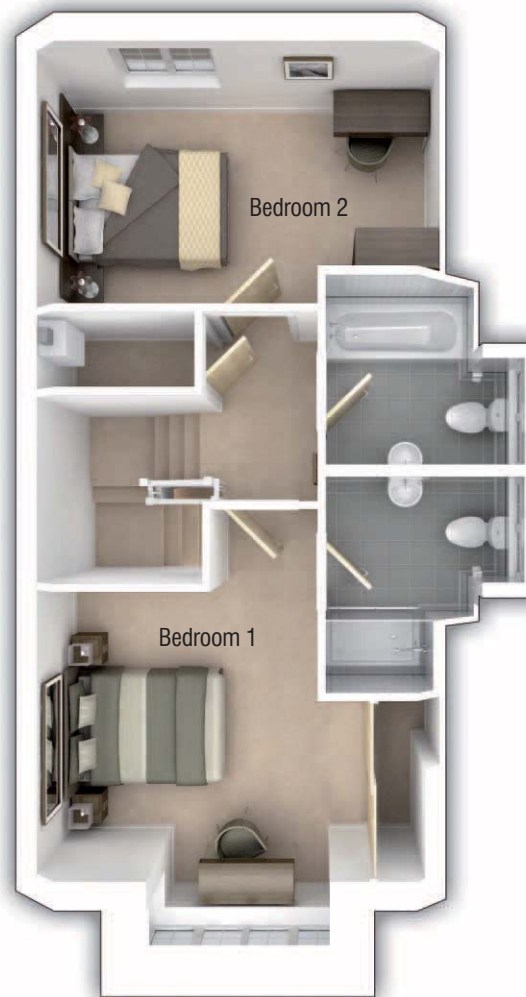

First floor

Bedroom 1	4.57m x 3.21m 14'11" x 10'6"
Bedroom 2	4.57m x 2.91m 14'11" x 9'6"
Bathroom	2.37m x 2.13m 7'9" x 6'11"
En suite	2.37m x 2.41m 7'9" x 7'10"

All measurements shown are approximate maximum room dimensions.

Please turnover for the correct orientation of room layouts for plot numbers **17, 23, 24, 31, 40, 49, 51** and **57** ➤

The Harrington

Three bedroom chalet bungalow



Front view

Rear view

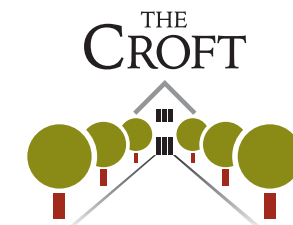

(H104)



Ground floor

Kitchen	3.60m x 4.91m 11'9" x 16'1"
Living Room	4.57m x 3.19m 14'11" x 10'5"
Dining Room / Bedroom 3	2.67m x 3.80m 8'9" x 12'5"
Shower Room	1.71m x 1.86m 5'7" x 6'1"

All measurements shown are approximate maximum room dimensions.

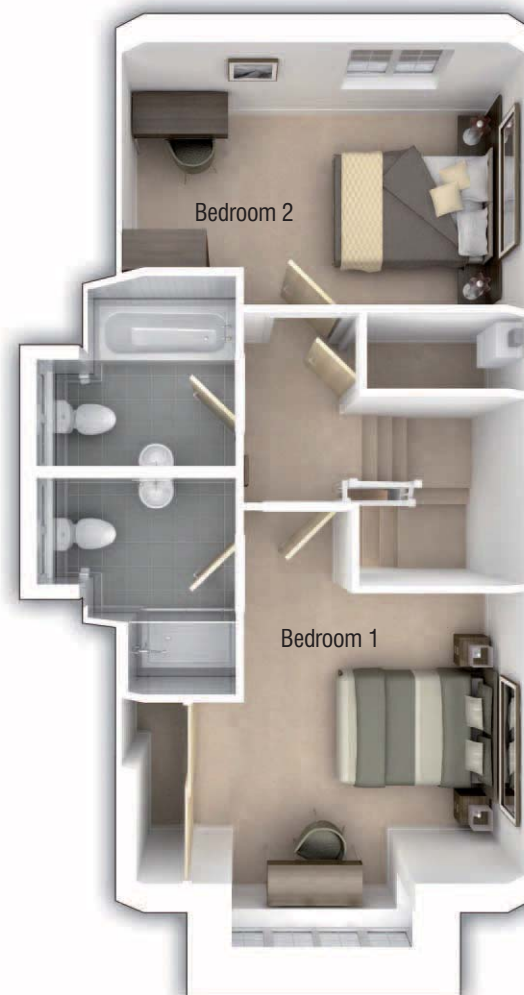

First floor

Bedroom 1	4.57m x 3.21m 14'11" x 10'6"
Bedroom 2	4.57m x 2.91m 14'11" x 9'6"
Bathroom	2.37m x 2.13m 7'9" x 6'11"
En suite	2.37m x 2.41m 7'9" x 7'10"

All measurements shown are approximate maximum room dimensions.

The Harrington is named after Robert Harrington (1589 - 1654) who made large bequests to Bourne from which the community benefits to this day.